

HOME VENTILATION PRODUCTS

FV4LCD - S-Touch Home Ventilation System

ABOUT THE S-TOUCH VENTILATION SYSTEM

What is the S-Touch Home Ventilation System?

The S-Touch is an unobtrusive ventilation system that pushes out the moisture-laden air responsible for the condensation in your home, gently introducing fresh, filtered air from outside the home.

Running costs

The S-Touch FV4LCD home ventilation system has an average running cost equivalent to that of a 60 watt light bulb.

Reduce maintenance of your home

By reducing condensation and dampness in your home, you eliminate unnecessary maintenance such as peeling wallpaper, flaking paint, mouldy curtains and damaged window sills and sashes.

Continuous air changes to help rid odours

The S-Touch home ventilation system is continuously introducing fresh, filtered air into your home, which assists in reducing odours produced by cooking, smoking and household pets.

Air Filtration

When you introduce fresh filtered air in to the home, you infinitely reduce pollens, moulds, dusts, and fungi, making that air safer and cleaner to breathe.

Even distribution of heat around the home saving you money!

Your existing heating system will perform more efficiently using less energy to heat a drier home.

Free solar gain from the roof space

At certain times of the day, your home ventilation system will benefit from the warm air produced in your roof space and will distribute this warm air into the home.



Solving Dampness

Life inside today's tight homes generates both moisture and pollutants. The moisture comes from cooking, washing, showers and breathing.

At excessive levels, moisture condenses on windows and can cause structural deterioration.

Areas of excessive moisture are also a breeding ground for mould, mildew, fungi, dust mites and bacteria.

You know you have a problem if you find moisture collecting on your windows, or if you notice black spots on your walls. These unsightly spots indicate mildew growth. Mould spores and dust easily become airborne and circulate freely throughout the house, possibly causing a range of illness and allergic reactions.

FV4LCD - S-Touch Home Ventilation System

SYSTEM FEATURES:

- Dual Temperature Sensing (home and roof cavity)
- 12 Fully Automatic Control Modes
- 6 Manual Control Modes
- Filter Change Indicator
- Touch Screen LCD Display
- Temperature Control Set Points
- Variable Speed Fan Motor

SPECIFICATIONS

- F6 Rated Pleated Box Filter
- Total Product Wattage: 85 Watts
- Free Air Fan Performance: 820m³/hr / 227.8l/sec
- Cavity Clearance Required: 890mm
- Ceiling Cutout Size: 155mm



Touch Screen LCD Control Panel
Dual Temperature Display and Function Override



Main fan unit (FV4LCD shown*)
(also available 5,6,7,8 outlet units)

HOME VENTILATION ACCESSORIES

AF4 - Add-on Fresh Air Kit for S-Touch Ventilation System

WHAT DOES IT DO?

When the Fresh function is set from the touch pad and the temperatures are within the range the fresh kit will operate to shut off the air supply from the ceiling cavity and bring fresh cool filtered air in from the outside.

When the fresh function starts, Fan speeds can be adjusted to control the flow of air.

The function can be set at any time but will only begin when the home temperature is over the set point.

The system will automatically switch back to home ventilation mode if the house temperature drops below the set point.



Fresh Air Unit

AFHT - Add-on Heat Transfer Kit for S-Touch Ventilation System

WHAT DOES IT DO?

The S-touch system will act as a heat transfer system, distributing the warmth throughout the home.

The heat transfer add-on is controlled by a thermostat located in the heat source room, as the room temperature rises, and the thermostat is activated the heat transfer kit will divert the source of air for the ventilation system from the ceiling cavity to the internal room with the heat source.

When ever the temperature at the thermostat drops below the thermostat set point the transfer fan will switch to Auto ventilation mode until the room temperature increases again and it can transfer heat again.

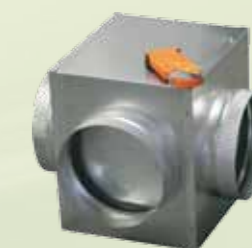

Heat Transfer Unit

FH800 - Add-on 1kw Duct Warmer for S-Touch Ventilation System

WHAT DOES IT DO?

The air-tempering unit is used to warm incoming air to your home on cool winter nights.

The duct warmer works in conjunction with your S-Touch Ventilation System.

The unit contains a 1,000-watt element which is electronically controlled from the S-Touch Ventilation System running at variable wattages from 100~1000w for optimal efficiency and power control.

Warming temperature is based on your ceiling cavity temperature, and the program setting you have selected.



Duct Warmer

Simple DIY Installation:



HOME VENTILATION PRODUCTS

FV814 - 4 Outlet Home Ventilation System

SYSTEM FEATURES:

- Dual Temperature Sensing (home and roof cavity)
- 4 Automated Control Modes
- 3 Manual Speed Settings
- Filter Change Indicator
- Dual Line LCD Display
- Temperature Control Set Points
- Variable Speed Fan Motor

SPECIFICATIONS

- Total Product Wattage: 85 Watts
- Free Air Fan Performance: 580m³/hr / 161.1l/sec
- Cavity Clearance Required: 890mm
- Ceiling Cutout Size: 155mm



Dual Line LCD
Control Panel
Dual Temperature
Display



Main fan unit
shown with
ducting, vents
and control panel

HOME VENTILATION ACCESSORIES

FH800 - Add-on 1kw Duct Warmer for FV814 Ventilation System

WHAT DOES IT DO?

The air-tempering unit is used to warm incoming air to your home on cool winter nights.

The duct warmer works in conjunction with your FV814 Ventilation System.

The unit contains a 1,000-watt element which is electronically controlled from the FV814 Ventilation System running at variable wattages from 300~1000w for optimal efficiency and power control.

Warming temperature is based on your ceiling cavity temperature, and the program setting you have selected.



Duct Warmer

HOME VENTILATION FAQ'S

HOW SIMPLE IS IT TO OPERATE THE UNIT?

The Weiss HVS is very user friendly, and comes complete with clear operational instructions. By selecting auto mode and the program number based on your house size, the unit will automatically adjust it self to suit your home.

WHAT MAINTENANCE IS REQUIRED?

The only maintenance requirement for the Weiss HVS is the changing of the filter. The microprocessor touch pad will indicate the filter change requirement at the end of the filter cycle.

HOW LONG UNTIL I KNOW WHETHER OR NOT THE WEISS HVS UNIT IS WORKING?

Most homeowners notice a dramatic reduction in condensation and mould build up within a period of two-four weeks.

DO I NEED TO SWITCH THE WEISS HVS OFF IN SUMMER?

It is recommended that the Weiss HVS is left on continuously, as the unit is fitted with dual microprocessors that sense temperature in the roof cavity and the home, and adjusts itself accordingly, to suit both summer and winter climates.

Weiss Limited
PO Box 204-120
Highbrook, Auckland

Phone: (09) 274-4113
Fax: (09) 274-1880
Email: nz.sales@weiss.co.nz



WEISS™

Home Ventilation Product Range

<http://www.weiss.co.nz>

